

Dimensions:

Part No.	Description	Length (mm)	Width (mm)	Height (mm)	Weight (kg)
431350	Tamar 10W/20W 2ft Twin*	610	75	81	0.75
431351	Tamar 20W/40W 4ft Twin	1165	75	81	1.4
431352	Tamar 25W/50W 5ft Twin	1465	75	81	1.65
431353	Tamar 30W/60W 6ft Twin	1795	75	81	2.0

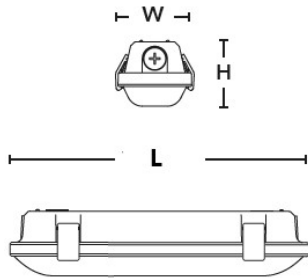

End Of Life Disposal:

Disassembly instructions for end of life disposal available on website.
Disposal of Electronic Equipment WEEE Directive 2002/96/EC This product falls within the scope of the Waste Electrical & Electronic Equipment Directive (WEEE), which means the product should not be disposed of as normal household waste. Please recycle where facilities exist or check with your Local Authority. RoHS - All components and materials used in this product are RoHS 2002/95/EC compliant. Specifications may change from time to time. The information contained in this leaflet is for guidance only and should not be considered as always accurate and should be treated as not representative.

Installation Instructions



Tamar Plug & Play Anti-Corrosive

Input	220-240V AC 50/60Hz
Power	10/20W 20/40W 25/50W 30/60W
Operating Temp	-20°C ~ +40°C
Connection Type	Push-Fit Terminal
Emergency Option	430962 (Sold Separately)*
Control Connection	430916 (Sold Separately)
Light Source Energy Rating	B



Box Contents:

- Tamar Anti-Corrosive
- Fixing Kit

Selectable Emergency

Beam Angle

Professionally Replaceable

Professionally Replaceable

Class I

Ingress Protection

Tools Required For Installation:

- Wire Strippers / Cutter
- Screwdriver / Impact Driver
- Drill

* Please note P&P Emergency not available in 2ft Tamar

READ THESE INSTRUCTIONS THOROUGHLY BEFORE INSTALLATION
KEEP THESE INSTRUCTIONS FOR FUTURE REFERENCE.

IMPORTANT:
This product must be installed by a qualified electrician or competent person, and in accordance with current building and IET wiring regulations.

Warranty:

This luminaire is warranted for a period of 5 Years from the date of purchase**. The warranty could be invalidated should the light fitting not be installed according to these instructions, outside the scope of the specification or the product has been altered or tampered with in any way. Please see website for terms and conditions.



WARNING: Risk of electric shock!
Isolate the mains power before proceeding.

- Turn off the mains power before performing inspections, installation, or removal
- Verify that the supply voltage is correct by comparing it with the luminaire label information
- It is the installers responsibility to ensure installation is suitable for the total load of the luminaire(s). The supply cable, fuses/circuit breakers must be correctly rated for the electrical load and considering for any transient inrush currents that may occur.
- Do not perform insulation strength or resistance tests on installed luminaire(s) connected

Wiring instructions for units equipped with EMERGENCY function:

Emergency lighting luminaire must be installed and maintained in accordance with the emergency lighting standards BS 5266-1.

- For the emergency function to operate correctly an uninterrupted permanent live feed must be present and connected to the 'Permanent Live' terminal of the main terminal block. Please ensure there are no manual or automatic switches (other than dedicated emergency test switches), PIRs or any other switching methods along the permanent live feed, as regular switching of the emergency pack could result in premature battery failure.
- Once powered up the green LED indicator will illuminate to indicate charging. If power to the unit is disrupted or isolated the green indicator LED will switch off and the emergency LEDs will illuminate.
- Following power up of the emergency unit in self-test mode, and after 24 hours of uninterrupted charge time, a 3hr emergency duration test will be performed automatically by the unit. When used in self-test mode a manual emergency test switch must not be used for testing at any time.

Installation Procedure:

1. Ensure power is off and safe isolation procedures are followed.
2. Carefully measure and install the mounting clips in desired location.
3. Open the diffuser by undoing the fasteners along the edge of the fitting.
4. Fix the cable gland or conduit connector to allow for power cable entry.
5. Connect mains cables to terminal block as indicated. The Permanent Live terminal is only utilised for emergency luminaires.
6. Select required power output level on switches, located on the driver.
7. Fix the diffuser by securing the fastening clips back in place.
8. Reconnect the mains supply and test the operation of the luminaire.

1.

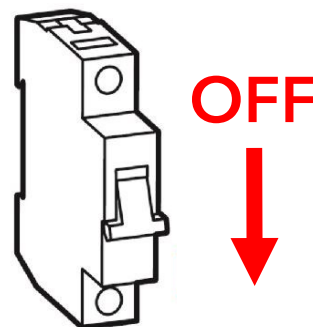

2.

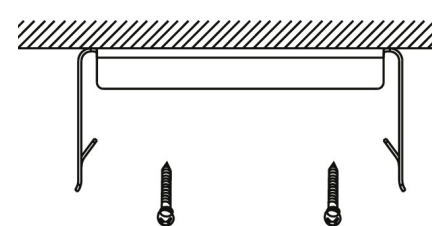

3.

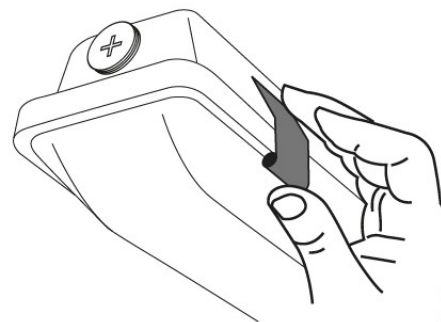

4.

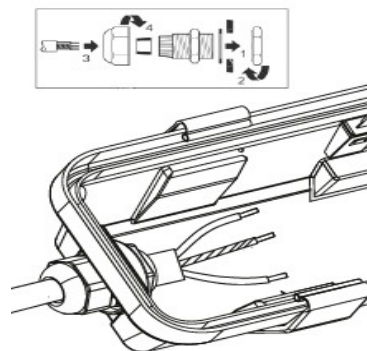

5.

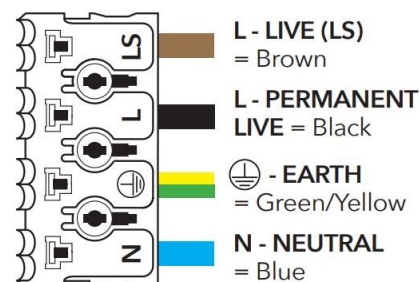

6.

Watts	Wattage Select
20W	ON
40W	ON

7.

